

Olivine 21

 4
  2
  2

Designed for 12.5m+ blocks, the Olivine 21 features 4 bedrooms, 2 bathrooms, and a 2-car garage over a single-storey. It boasts an open-plan living area at the home's hub and a master suite towards the rear. This home balances space and freedom with a home theatre and a laundry cleverly tucked away behind the kitchen. Its floor plan facilitates convenience in day-to-day activities while providing ample space for family enjoyment.

EMERGE

House Area

200.96 m²

Min Lot Size (WxL)

12.5m x 28m

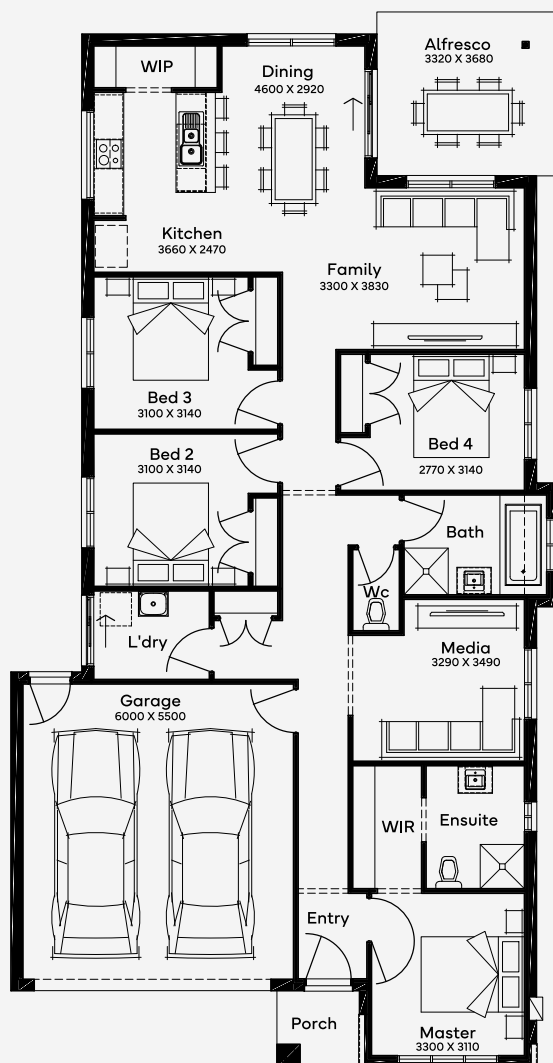

Please note: Some floorplan option combinations may not be possible together. Please speak to a New Home Specialist.
Base price shown as of 24 January 2026 and is subject to change.

SIMONDS
How Australia Homes

12.5M+ LOT WIDTH

SINGLE STOREY