

# Granite 22



The Granite 22, a 4-bedroom, 2-bathroom home with 2 living spaces, is single-storey, designed for a 12.5m+ block, catering to the dynamics of a busy family. It features a large kitchen with a diner-style brunch bar and a hidden butler's pantry, overlooking a spacious dining and living area with a welcoming atmosphere. The home's layout includes three centrally located bedrooms for children, while the master suite is a secluded sanctuary strategically placed behind the lounge at the entrance. This design epitomises modern living with spaces that adapt to both lively family interactions and tranquil moments.

EMERGE

House Area

205.18 m<sup>2</sup>

Min Lot Size (WxL)

12.5m x 28m

12.5M+ LOT WIDTH

SINGLE STOREY

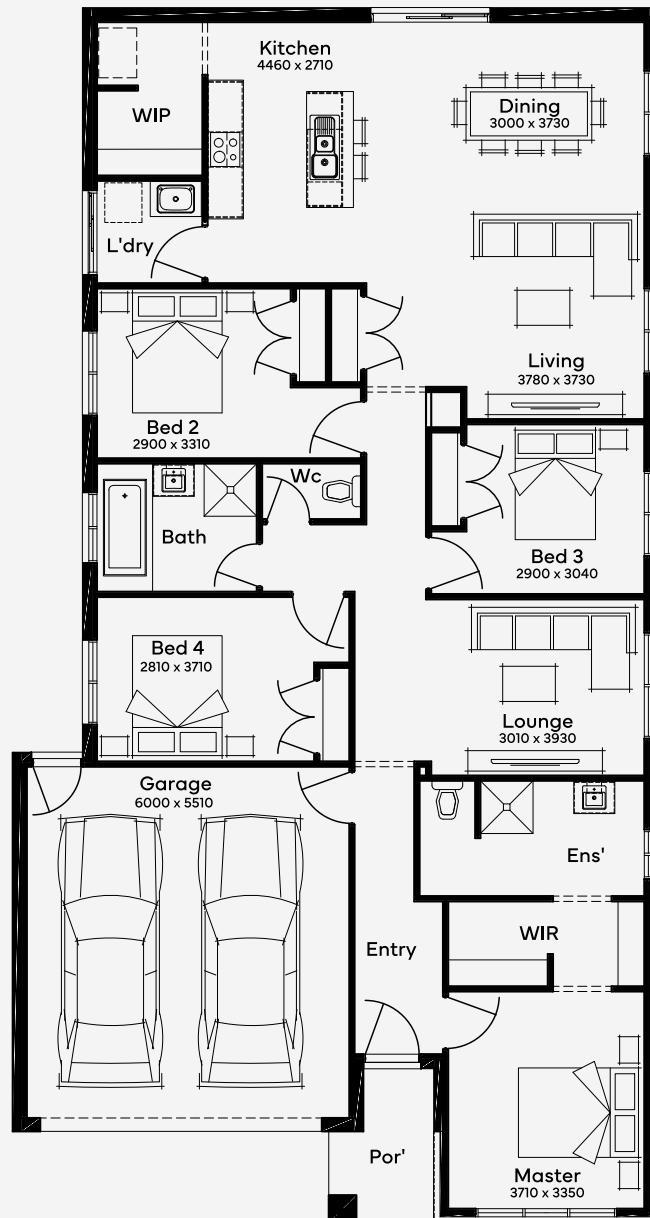

Please note: Some floorplan option combinations may not be possible together. Please speak to a New Home Specialist.  
Base price shown as of 29 October 2024 and is subject to change.

