

Cherryville 27



ELITE

House Area

258.23 m²

Min Lot Size (WxL)

30m x 20m

The 4-bedroom, 3-bathroom Cherryville 27 is a traditional homestead but not as you know it. Designed for 30m+ blocks, this acreage family home delivers comfortable living from all angles. You'll sleep well in a large master suite with an ensuite and walk-in robe, as well as 3 separate generously proportioned bedrooms. The spacious kitchen, dining and family is centrally located within the home, while a front living is perfect for formal entertaining or a home theatre.

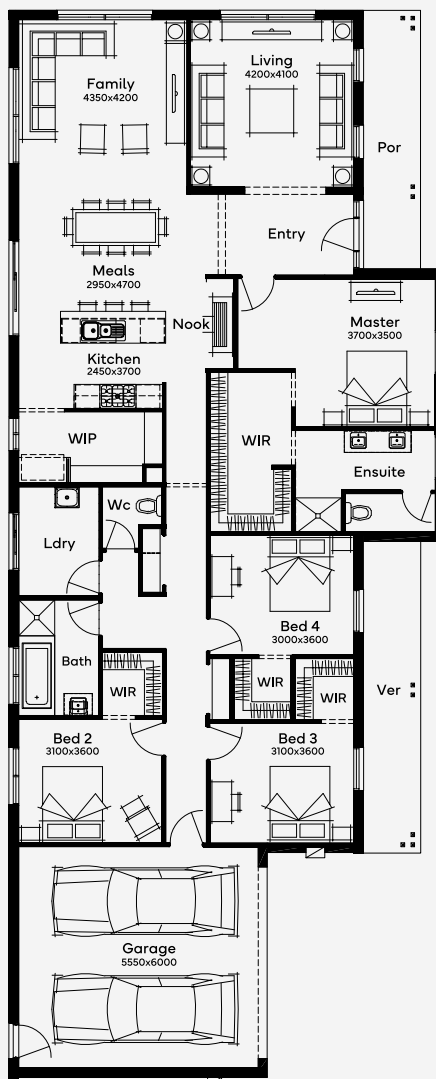

30M+ LOT WIDTH

SINGLE STOREY

Please note: Some floorplan option combinations may not be possible together - please speak to a New Home Specialist.
Base price shown as of 08 September 2024 and is subject to change.

SIMONDS
How Australia Homes